

KITCHEN
PLAN

Use this grid to draw a plan of your kitchen - how you would like it!

Name:

Address:

.....

.....

Postcode:

Telephone:

Mobile:

Email:

Any other information you think we should know:

.....

.....

.....

.....

.....

Please use this plan to quote me for a:

- Victorian
- Living
- Harvest
- Classic
- Maison
- Provencal

Return to:

Watercombe Park, Lynx Trading Estate,
Yeovil, Somerset BA20 2HL

01935 434 700

kitchens@oldcreameryfurniture.com

We offer a free, no obligation design service. If a visit to the showroom is difficult why not use our graph, enclosed, to get the ball rolling? Mark out simple dimensions, positions of doors windows and appliances. Included a wish list of pieces, based on our images and future usage, eg. storage or display. Plots & plans will be exchanged and sifted through, cost effective solutions found, we have literally hundreds of variations... designs sent out for feedback and fine tuning and when all agreed, approval. The whole process is relatively painless, yet still very involving. Remember to include:

- Your address and contact details, ideally email (see overleaf).
- A dimensional room plan, in metric for accuracy, if possible, showing windows and doors, size and position of planned appliances.
- Bear in mind, base units can be linked with common worktops to form runs and because of the bespoke nature of the furniture, if there are pieces that do not fit certain gaps, then they can be made specially for you.

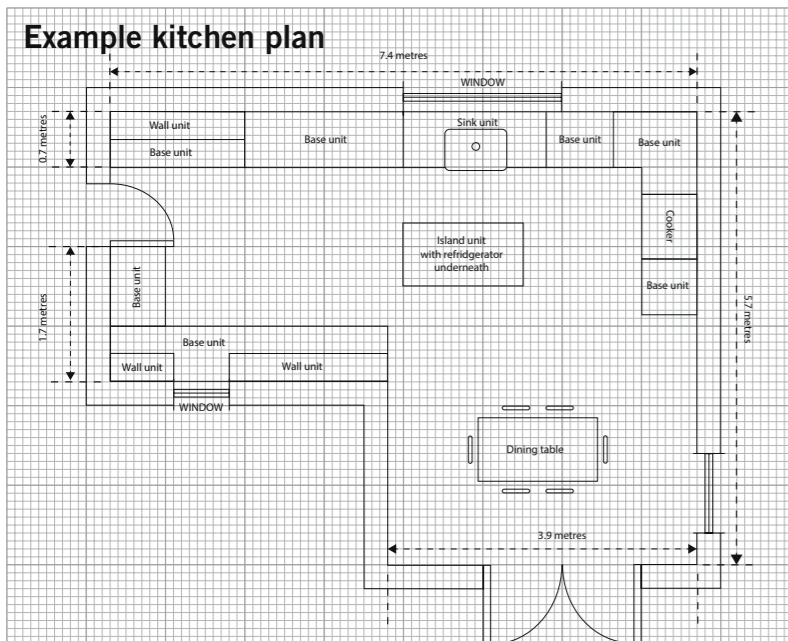

CREAMERY *Kitchens*

Kitchens with personalities...



Things to remember when planning a kitchen:

- You may consider positioning your sink under a window to let in light and to give you a view.
- Never position your cooker and sink closer than 500mm apart for safety reasons.
- Base units have recessed section in back to cope with pipework etc. but these can be noted to help plans.